

**KEY TO DRAWING**

EXISTING BUILDING C 200m<sup>2</sup> with 135m<sup>2</sup> new extension  
 BUILDING 1 388m<sup>2</sup> (+ 53m<sup>2</sup> canopy)  
 Trusses from Manor House Farm  
 forming new open fronted Cattle Shed  
 BUILDING 2 836m<sup>2</sup> (+ 152m<sup>2</sup> canopy)  
 New steel framed open fronted Cattle Shed  
 BUILDING 3 500m<sup>2</sup>  
 Trusses from Manor House Farm  
 with lean-to side extension  
 forming new pole bar for straw storage  
 BUILDING 4 377m<sup>2</sup> (+ 70m<sup>2</sup> canopy)  
 New steel framed open fronted Cattle Shed

TOTAL AREA OF RETAINED BUILDINGS (C) ..... 200m<sup>2</sup>  
 TOTAL AREA OF DEMOLISHED BUILDINGS (A+B) ..... 1,240m<sup>2</sup>  
 TOTAL AREA OF NEW BUILDINGS (ext. to C +1+2+3+4). 2,236m<sup>2</sup>  
 TOTAL INCREASE IN AREA OF BUILDINGS ON SITE ..... 996m<sup>2</sup>

OVERALL SITE AREA ... 5,650m<sup>2</sup>

APPROVED FOR CONSTRUCTION BY THE LOCAL AUTHORITY  
 ON 12/11/2014  
 DRAWING NO. 02  
 PROJECT NO. 14/011  
 CLIENT: MR ANDREW THORNTON  
 ADDRESS: MANOR HOUSE FARM, EAST LUTTON, YO17 8TG  
 CONTACT: 01653 658 229  
 davidward589@btinternet.com

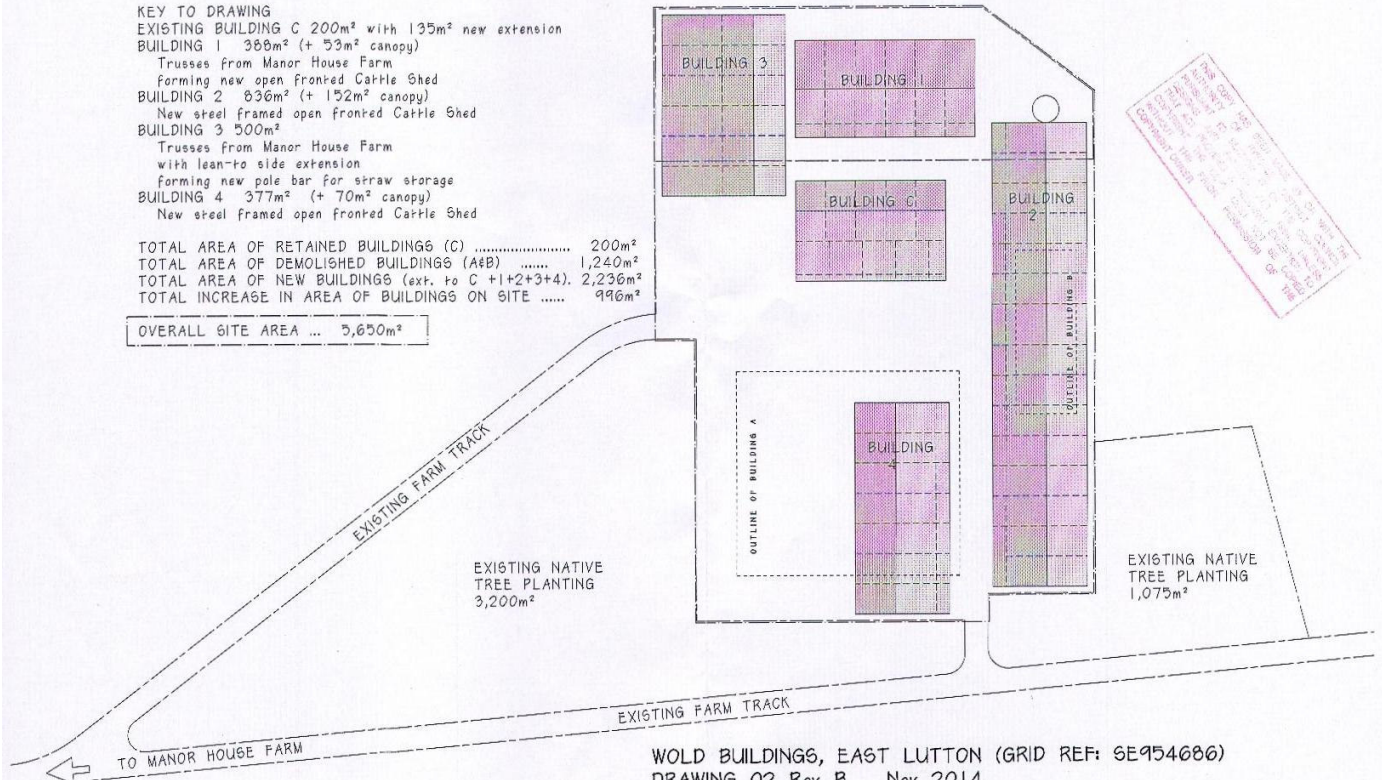

WOLD BUILDINGS, EAST LUTTON (GRID REF: SE954086)  
 DRAWING 02 Rev B Nov 2014  
 EXISTING PLAN (2014) SCALE: 1:500  
 MR ANDREW THORNTON, Manor House Farm, East Lutton, YO17 8TG  
 David Ward Architectural Ltd. 01653 658 229  
 davidward589@btinternet.com

KEY TO DRAWING

BUILDING A 1,020m<sup>2</sup>

Stone U shaped fold yard bathy and stables  
with pole ban in fold yard area

All now Demolished

BUILDING B 220m<sup>2</sup>

War time Nissan hut

Now demolished

BUILDING C 200m<sup>2</sup>

Fully clad storage barn with fibre cement roof

Now extended & incorporated into the current scheme

Two areas of existing landscape planting ..... 4,275m<sup>2</sup>

Area of former field now leveled and built on ... 1,450m<sup>2</sup>

OVERALL SITE AREA ... 4,200m<sup>2</sup>

Approved for planning  
by the Council on 15/11/14  
under the provisions of the  
Town and Country Planning Act  
1990 (as amended) and the  
Town and Country Planning  
(General) Regulations 1988  
under the provisions of the  
Town and Country Planning Act  
1990 (as amended)

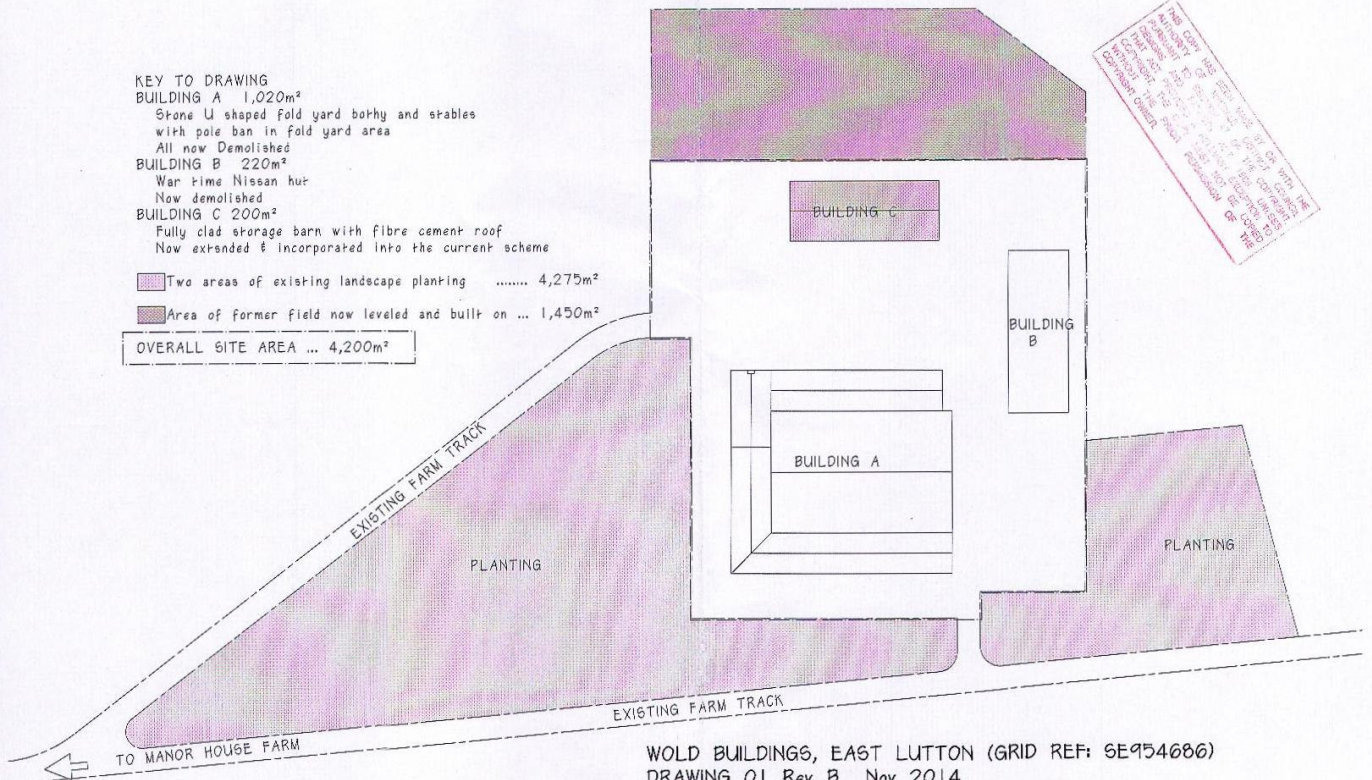

WOLD BUILDINGS, EAST LUTTON (GRID REF: SE954686)  
DRAWING 01 Rev B Nov 2014  
PRE DEVELOPMENT PLAN (2010) SCALE: 1:500  
MR ANDREW THORNTON, Manor House Farm, East Lutton, YO17 8TG  
David Ward Architectural Ltd. 01653 658 229  
davidward589@bt-internet.com